

44429441	<b>DATA SHEET</b>	
Valid from: 27.11.2020	<b>EPIC® H-B 10 DF</b>	

## Description

Docking frame for float mounting of rectangular inserts of the housing size H-B 10.

Mounting system for control cabinets.



## General characteristics

Series:	Docking frame
Size:	H-B 10
Insertion area:	
x-Axis:	+/-1,5mm
y-Axis:	+/-1,5mm
Cycles of mechanical operation :	>500
Weight:	85,6g

## Materials and surfaces

Frame:	Stainless steel
Screws:	Stainless steel

## Scope of delivery

- 1 Frame
- 4 Screws for mounting the frame

## Technical drawings and dimensions

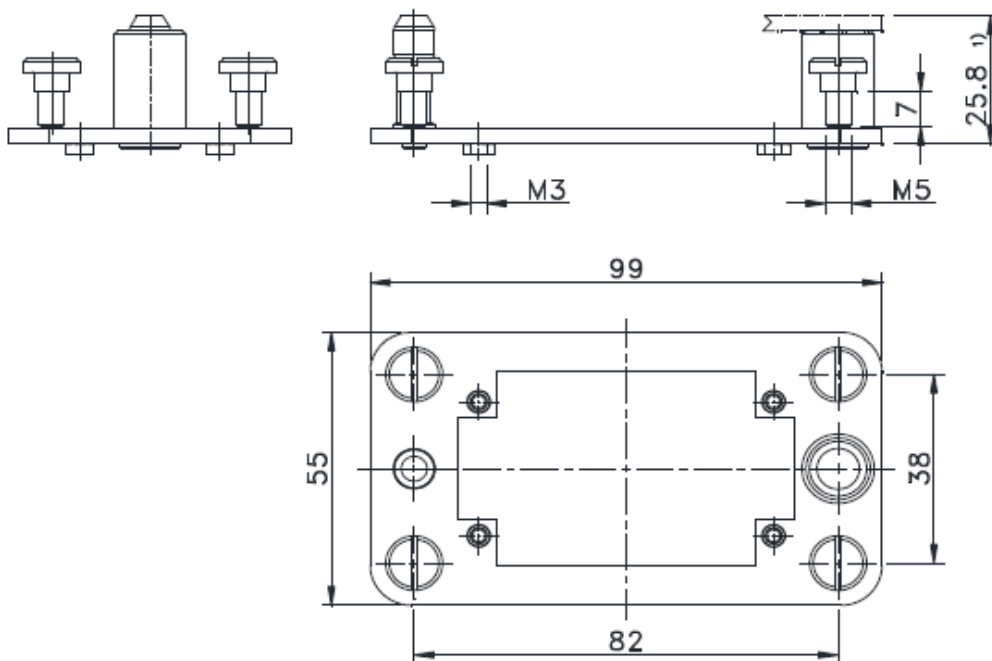

1) Distance for Contacts max. 27mm

Creator: STKU3/PDP Released: IVSE1/PDP	Document: DB44429441EN Version: 02	Page 1 of 2
---	---------------------------------------	-------------

44429441	<b>DATA SHEET</b>	
Valid from: 27.11.2020	EPIC® H-B 10 DF	

### Mounting cut-out

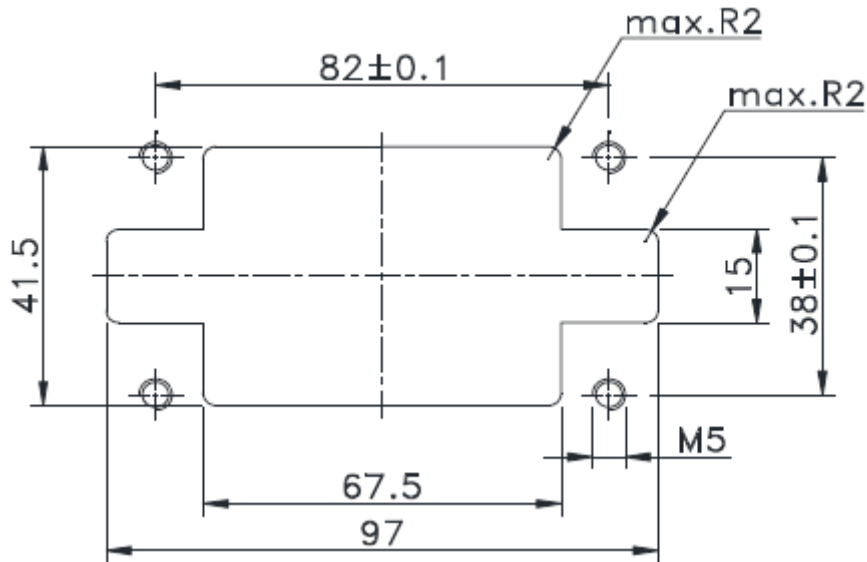

Automation

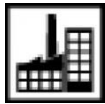

Industrial machinery and plant engineering



Mechanical resistance

### Application range

Control cabinets, wind turbines

### Remark

Photographs are not to scale and do not represent detailed images of the respective products.

Creator: STKU3/PDP Released: IVSE1/PDP	Document: DB44429441EN Version: 02	Page 2 of 2
---	---------------------------------------	-------------