

55510600	DATA SHEET	
Valid from: 03.07.2018	SILVYN® LTPS-M	

SILVYN® LTPS-M is an elbow Brass-Conduit gland with polyamide sealing for swivel applications. The gland can be used due to his properties in mechanical demanding environments.



- Material:** Gland – Brass, Nickel plated
Seal – PA
- Features:** High tensile strength
Oil resistant
Corrosion resistant
Halogen, Sulphur and Phosphorous free
Vibration and shock resistant
- Temperature range:** -50°C up to +135°C

Norm Reference:  
DIN EN 61386

Protection class: IP66, IP67, IP68 (5bar) and IP69K

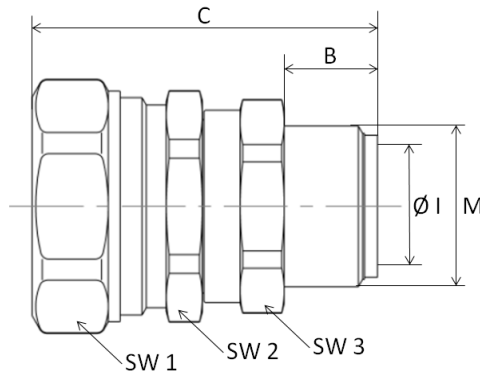

Dimension table:

Part No.	Description	NW	Thread M	Inner Diameter Ø I mm	Thread length B mm	Length C mm	SW 1	SW 2	SW 3
55510600	SILVYN® LTPS-M 16x1,5/1	12	M16x1,5	8,6	10,0	39,0	22	20	20
55510610	SILVYN® LTPS-M 16x1,5/2	16	M16x1,5	10,7	10,0	40,9	26	24	24
55510620	SILVYN® LTPS-M 20x1,5/1	16	M20x1,5	10,7	10,0	41,0	26	24	24
55510630	SILVYN® LTPS-M 20x1,5/2	20	M20x1,5	14,5	10,0	41,8	29	26	26
55510640	SILVYN® LTPS-M 25x1,5	25	M25x1,5	18,0	12,0	50,7	35	33	29
55510650	SILVYN® LTPS-M 32x1,5	32	M32x1,5	24,6	13,0	56,9	42	40	38

Suitable Conduit: SILVYN® LTP

Accessories: SKINDICHT® FLACHDICHTUNG

For more information please see our current catalogue. Please do not hesitate to contact our laboratory if there are any questions regarding resistance against aggressive agents and special oil.

Creator: M. Wegerer /PDP Released: DAMU1/PDP	Document: DB55510600EN Version: 02	Page 1 of 1
---	---------------------------------------	-------------