

73056111	<b>DATA SHEET</b>	
Valid from: 03.07.2018	<b>SILVYN® LGES-M</b>	

SILVYN® LGES-M is a conduit gland out of nickel plated brass and stainless steel, with an integrated sleeve for rotatable applications. The gland is suitable for SILVYN® SSUE and can be used in offshore applications and in demanding mechanical environments.



**Material:** Stainless steel  
Nickel plated brass

**Features:** High tensile strength  
High mechanical resistant  
Oil resistant  
Corrosion resistant  
Rotatable

**Temperature range:** SILVYN LGES-M (Stainless steel) -100 up to +400 °C  
SILVYN LGES-M (Nickel plated brass) -50 up to +300 °C

**Norm Reference:** 

**Note:** Conforms to DIN EN IEC 61386

**Protection class:** IP 40

**Suitable conduit:** SILVYN® SSUE



Creator: M. Wegerer /PDP Released: DAMU1/PDP	Document: DB55503210EN Version: 03	Page 1 of 2
---	---------------------------------------	-------------

73056111	<b>DATA SHEET</b>	
Valid from: 03.07.2018	<b>SILVYN® LGES-M</b>	

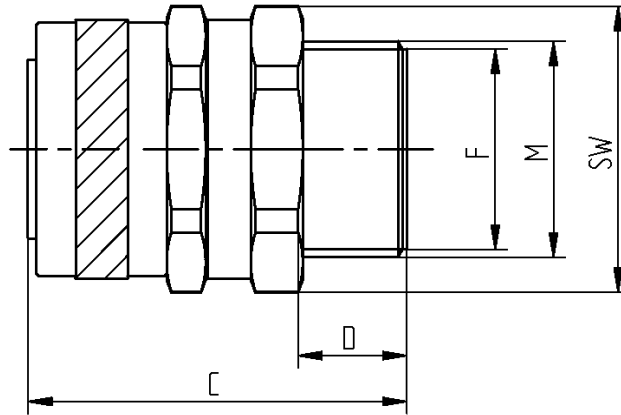

**Dimension table:**

Part No.	Part name	Thread M	Conduit nominal size	Length C mm	Thread length D mm	Inner Ø F mm	SW
<b>SILVYN LGES-M (Stainless steel)</b>							
5550 3210	SILVYN® LGES-M	M 12x1,5	10	30,2	8	5,6	14
5550 3211	SILVYN® LGES-M	M 16x1,5	12	32,2	8	8,5	19
5550 3212	SILVYN® LGES-M	M 16x1,5	16	34,2	10	11,5	19
5550 3213	SILVYN® LGES-M	M 20x1,5	20	35,5	10	15,3	24
5550 3214	SILVYN® LGES-M	M 25x1,5	25	43,7	10	19,1	29
5550 3215	SILVYN® LGES-M	M 32x1,5	32	48,0	13	26,2	38
<b>SILVYN LGES-M (Nickel plated brass)</b>							
5550 3489	SILVYN® LGES-M	M 12x1,5	10	30,2	8	5,6	13
5550 3490	SILVYN® LGES-M	M 16x1,5	12	32,2	8	8,5	17
5550 3491	SILVYN® LGES-M	M 16x1,5	16	34,2	10	11,5	20
5550 3492	SILVYN® LGES-M	M 20x1,5	16	34,2	10	11,5	22
5550 3493	SILVYN® LGES-M	M 20x1,5	20	35,5	10	15,3	24
5550 3494	SILVYN® LGES-M	M 25x1,5	25	43,7	12	19,1	29
5550 3495	SILVYN® LGES-M	M 32x1,5	32	48,0	13	26,2	38
5550 3496	SILVYN® LGES-M	M 40x1,5	40	51,2	14	34,2	48
5550 3497	SILVYN® LGES-M	M 50x1,5	50	54,2	15	44,8	58
5550 3498	SILVYN® LGES-M	M 63x1,5	63	63,2	18	54,5	70

For more information please see our current catalogue. Please do not hesitate to contact our laboratory if there are any questions regarding resistance against aggressive agents and special oil.

Creator: M. Wegerer /PDP Released: DAMU1/PDP	Document: DB555032 10EN Version: 03	Page 2 of 2
---	--	-------------