

|                           |                            |   |
|---------------------------|----------------------------|---|
| 19076000                  | <b>DATA SHEET</b>          |  |
| Valid from:<br>17.09.2018 | <b>EPIC® H-B 16 SDR-BO</b> |   |

## Description

- The housing standard.
- Wide choice for all applications.



## General Characteristics

|                              |  |
|------------------------------|--|
| Series                       | H-B 16                                   |
| Version                      | Surface mount base M 25                  |
| Protection cover             | Yes                                      |
| Cable entry                  | 1  |
| Locking                      | Bolts for double lever                   |
| Protection (DIN EN 60529)    | IP 65 (latched)<br>IP 40 (cover closed)  |
| Protection (NEMA 250, UL50E) | 4, 12 (latched)                          |
| Temperature Range            | -40°C to +100°C, short term up to +125°C |

## Materials and Surfaces

|         |                                     |
|---------|-------------------------------------|
| Housing | Aluminium alloy powder-coated, grey |
| Cover   | Zinc alloy powder-coated, grey      |
| Bolt    | Zinc-plated steel                   |
| Sealing | NBR                                 |

## Approvals

|                            |      |
|----------------------------|------|
| VDE-Approval, VDE-REG.-Nr. | B437 |
|----------------------------|------|

## Standard

|                 |           |
|-----------------|-----------|
| Safety Standard | IEC 61984 |
|-----------------|-----------|

|   |                                       |             |
|---|---------------------------------------|-------------|
| Creator: MANA2/PDP<br>Released: IVSE1/PDP | Document: DB19076000EN<br>Version: 02 | Page 1 of 2 |
|---|---------------------------------------|-------------|

|                           |                     |   |
|---------------------------|---------------------|---|
| 19076000                  | <b>DATA SHEET</b>   |  |
| Valid from:<br>17.09.2018 | EPIC® H-B 16 SDR-BO |   |

## Technical Drawings

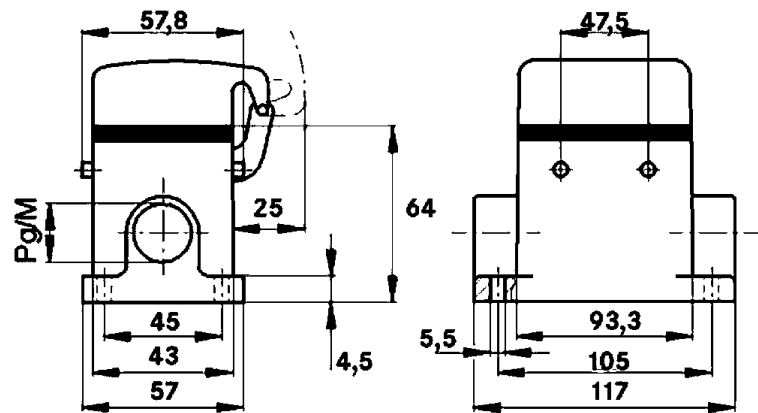

Automation



Industrial machinery and plant engineering



Mechanical resistance



Robust



Waterproof

### Info

Universal, robust metal housings size H-B 16

### Application range

Plant engineering  
Light & sound technology  
Plastics industry

### Remark

Photographs are not to scale and do not represent detailed images of the respective products.

|   |                                       |             |
|---|---------------------------------------|-------------|
| Creator: MANA2/PDP<br>Released: IVSE1/PDP | Document: DB19076000EN<br>Version: 02 | Page 2 of 2 |
|---|---------------------------------------|-------------|